



Monitor

User Manual

User Manual

COPYRIGHT ©2019 Hangzhou Hikvision Digital Technology Co., Ltd.

ALL RIGHTS RESERVED.

Any and all information, including, among others, wordings, pictures, graphs are the properties of Hangzhou Hikvision Digital Technology Co., Ltd. or its subsidiaries (hereinafter referred to be “Hikvision”). This user manual (hereinafter referred to be “the Manual”) cannot be reproduced, changed, translated, or distributed, partially or wholly, by any means, without the prior written permission of Hikvision. Unless otherwise stipulated, Hikvision does not make any warranties, guarantees or representations, express or implied, regarding to the Manual.

About this Manual

This Manual is applicable to Standing *Monitor*

The Manual includes instructions for using and managing the product. Pictures, charts, images and all other information hereinafter are for description and explanation only. The information contained in the Manual is subject to change, without notice, due to firmware updates or other reasons. Please find the latest version in the company website (<http://overseas.hikvision.com/en/>).

Please use this user manual under the guidance of professionals.

Trademarks Acknowledgement

- **HIKVISION** and other Hikvision’s trademarks and logos are the properties of Hikvision in various jurisdictions.
- Other trademarks and logos mentioned are the properties of their respective owners.

Legal Disclaimer

TO THE MAXIMUM EXTENT PERMITTED BY APPLICABLE LAW, THE PRODUCT DESCRIBED, WITH ITS HARDWARE, SOFTWARE AND FIRMWARE, IS PROVIDED “AS IS”, WITH ALL FAULTS AND ERRORS, AND OUR COMPANY MAKES NO WARRANTIES, EXPRESS OR IMPLIED, INCLUDING WITHOUT LIMITATION, MERCHANTABILITY, SATISFACTORY QUALITY, FITNESS FOR A PARTICULAR PURPOSE, AND NON-INFRINGEMENT OF THIRD PARTY. IN NO EVENT WILL OUR COMPANY, ITS DIRECTORS, OFFICERS, EMPLOYEES, OR AGENTS BE LIABLE TO YOU FOR ANY SPECIAL, CONSEQUENTIAL, INCIDENTAL, OR INDIRECT DAMAGES, INCLUDING, AMONG OTHERS, DAMAGES FOR LOSS OF BUSINESS PROFITS, BUSINESS INTERRUPTION, OR LOSS OF DATA OR DOCUMENTATION, IN CONNECTION WITH THE USE OF THIS PRODUCT, EVEN IF OUR COMPANY HAS BEEN ADVISED OF THE POSSIBILITY OF SUCH DAMAGES.

REGARDING TO THE PRODUCT WITH INTERNET ACCESS, THE USE OF PRODUCT SHALL BE WHOLLY AT YOUR OWN RISKS. OUR COMPANY SHALL NOT TAKE ANY RESPONSIBILITIES FOR ABNORMAL OPERATION, PRIVACY LEAKAGE OR OTHER DAMAGES RESULTING FROM CYBER ATTACK, HACKER ATTACK, VIRUS INSPECTION, OR OTHER INTERNET SECURITY RISKS; HOWEVER, OUR COMPANY WILL PROVIDE TIMELY TECHNICAL SUPPORT IF REQUIRED.

SURVEILLANCE LAWS VARY BY JURISDICTION. PLEASE CHECK ALL RELEVANT LAWS IN YOUR JURISDICTION BEFORE USING THIS PRODUCT IN ORDER TO ENSURE THAT YOUR USE CONFORMS THE APPLICABLE LAW. OUR COMPANY SHALL NOT BE LIABLE IN THE EVENT THAT THIS PRODUCT IS USED WITH ILLEGITIMATE PURPOSES.

IN THE EVENT OF ANY CONFLICTS BETWEEN THIS MANUAL AND THE APPLICABLE LAW, THE LATER PREVAILS.

Regulatory Information

FCC Information

Please take attention that changes or modification not expressly approved by the party responsible for compliance could void the user's authority to operate the equipment.

FCC compliance: This equipment has been tested and found to comply with the limits for a Class A digital device, pursuant to part 15 of the FCC Rules. These limits are designed to provide reasonable protection against harmful interference when the equipment is operated in a commercial environment. This equipment generates, uses, and can radiate radio frequency energy and, if not installed and used in accordance with the instruction manual, may cause harmful interference to radio communications. Operation of this equipment in a residential area is likely to cause harmful interference in which case the user will be required to correct the interference at his own expense.

FCC Conditions

This device complies with part 15 of the FCC Rules. Operation is subject to the following two conditions:

1. This device may not cause harmful interference.
2. This device must accept any interference received, including interference that may cause undesired operation.

EU Conformity Statement



This product and - if applicable - the supplied accessories too are marked with "CE" and comply therefore with the applicable harmonized European standards listed under the EMC Directive 2014/30/EU, the LVD Directive 2014/35/EU, the RoHS Directive 2011/65/EU.



2012/19/EU (WEEE directive): Products marked with this symbol cannot be disposed of as unsorted municipal waste in the European Union. For proper recycling, return this product to your local supplier upon the purchase of equivalent new equipment, or dispose of it at designated collection points. For more information see: www.recyclethis.info



2006/66/EC (battery directive): This product contains a battery that cannot be disposed of as unsorted municipal waste in the European Union. See the product documentation for specific battery information. The battery is marked with this symbol, which may include lettering to indicate cadmium (Cd), lead (Pb), or mercury (Hg). For proper recycling, return the battery to your supplier or to a designated collection point. For more information see: www.recyclethis.info

Industry Canada ICES-003 Compliance



This device meets the CAN ICES-3 (A)/NMB-3(A) standards requirements.

Applicable Models

This manual is applicable to the Standing Monitor.

Symbol Conventions

The symbols that may be found in this document are defined as follows.

Symbol	Description
 NOTE	Provides additional information to emphasize or supplement important points of the main text.
 WARNING	Indicates a potentially hazardous situation, which if not avoided, could result in equipment damage, data loss, performance degradation, or unexpected results.
 DANGER	Indicates a hazard with a high level of risk, which if not avoided, will result in death or serious injury.

Safety Instructions

For safety concerns, the device has been strictly tested before shipment. However, incorrect installation or usage may lead to hazardous results such as electric shock and fire. To ensure the service life and best performance of the device, please read the notice and plate signs carefully and follow the safety instructions. Keep this guide properly for later use.



WARNING

- The device may generate radio interference in indoor environment. Necessary precautions may be required.
- Our company is not responsible for any fault caused by third-party when operating the device and other failure or damage incurred.
- Do not operate the device in an environment of dust, high humidity, or oil and steam contacting to avoid the risk of fire and damage.
- Do not place the device in:
 - Direct strong lighted, humid, over-heated/cooled, dusty environment.
 - An environment where flammable and explosive matter are stored and used.
 - An environment of flammable and corrosive gas.
 - Places like bathroom and kitchen.
- Do not operate the device in an environment of dust, high humidity, or oil and steam contacting to avoid the risk of fire and damage.

- Do not operate the device near heating device or place of high temperature to avoid the risk of fire.
- Do not damage the power cable:
 - Do not modify the cable in any form.
 - Do not place heavy matter on the cable.
 - Keep the power away from heat.
 - Do not disconnect the power plug by pulling the cable.
- Do not use damaged or unfit power socket. Make sure the plug and the socket are in good contact.
- Do not parallel multiple plugs in one socket to avoid fire risk caused by power overload.
- Do not approach the device with fire (e.g. a lit candle) to avoid the risk of fire or electric shock.
- Do not place anything containing liquid on the device to avoid the risk of fire or electric shock caused by liquid-splashing.
- Do not let sharp or metal articles and liquids contact the signal connectors or heat dissipation holes to avoid short circuit, product damage and electric shock.
- The hole on the shell is designed for heat dissipation. Do not block the hole when installing the device.
- Do not touch the device with a wet finger to avoid risk of electric shock.
- Contact professional technicians for repairing.
- To avoid the risk of electric shock, please do not operate when the power is on.
- Please do not frequently plug and unplug the power cable when the power is on.
- Keep small accessories away from children.
- Make sure the power supply matches the requirements specified by the plate on the shell.
- After moving the device from low temperature environment to high temperature environment, please do not turn on the device immediately and wait for the condensation to evaporate.
- Make sure the environment is dry and well-ventilated, and heat dissipation is good.
- The device and its accessories are subject to change without prior notice.
- The fragile materials of the display are vulnerable to falling and impact. Please hold with care.
- Scratching or knocking the device with hard objects is strictly forbidden. Do not frequently turn on/off the power of the device when operating to avoid the risk of damage and faults.
- If smoke, odor or noise rise from the device, turn off the power at once and unplug the power cable, and then please contact the service center.

Contents

Important Safety Precautions	5
1.Product Description	5
1.1 General	5
1.2 Packing List	5
2.Installation and Connection	6
2.1 Display Installation	6
2.2 Signal Line Connection	6
2.3 EarPhone Connection	6
3.Operation of Display	7
3.1 Power Indicator Light	7
3.2 Rocker Function Introduction	7
3.3 Safety Protection	7
4.Basic Troubleshooting	8
5.Technical Specifications of Product	8
6.Instruction of Base Installation	9

Important Safety Precautions

1. Please read all the instructions carefully before using this product.
2. BE SURE TO unplug the power cord when cleaning LCD. Never clean it with liquid detergent or spraying detergent, but wipe it with wet soft cloth. If it is still not clean, please use special detergent for LCD.
3. DO NOT use accessories not authorized by the manufacturer, otherwise they may incur danger.
4. When disconnecting the power cord of display or power adapter, always remember to hold the plug instead of pulling the wire to unplug the power cord.
5. Keep the display away from water sources such as bath tub, washbasin, sink or washing machine. DO NOT place the display on wet floor or near a swimming pool, or press LCD surface with fingers or hard objects.
6. The grooves and openings on the back and bottom of the shell are for ventilation purpose and also for guaranteeing the reliability of the elements and preventing them from overheating; in order to prevent the vents from blocking; DO NOT place the display on bed, sofa, carpet or other similar surface; DO NOT place the display near to or on heat radiator or heater; DO NOT place the display into embedded device, unless it is provided with adequate ventilating equipment.
7. Only the type of power source indicated on the nameplate applies to this display. If you have any question on the type of power source you use, please consult the dealer of the display or local administration of power supply.
8. For safety, the display or the power adapter is equipped with three-pin plug power cord. The third pin of this plug is for grounding, and only applicable to socket that is correctly grounded. In case that your socket is not available for the plug, please contact electrician to replace the socket.
9. Since there is high voltage or other risks when the shell is opened or moved, please DO NOT repair the display by yourself, but request qualified maintenance staff to carry out full maintenance.
10. In one of the following cases, please unplug the display or the power adapter and ask qualified maintenance staff for maintenance:
 - a. The power cord or the plug is impaired or worn.
 - b. The display falls off or the shell is damaged.
 - c. The display is obviously abnormal.
11. Please place the display in a cool, dry and well ventilated place.
12. Store the display in temperature range of -10°C~60°C, beyond which the display may be damaged permanently.

1. Product Description

1.1 General

This display is a high-performance smart multi-frequency scanning display. It adopts active-matrix TFT-LED backlight liquid screen and is controlled with MCU digital technology. With compact and thin appearance and build-in power supply, it is suitable for narrow work space.

1.2 Packing list

Please check the following items in the packing case before installation:

- One LCD display (including the base)
- One power cord (or attached to the display), one VGA signal line
- One User Manual

If any items are missing, please contact with the dealer.

NOTE: As for the accessories, please refer to the exact packing. please keep all the packing materials well for you may use them to pack these items when you need to move them.

2. Installation and Connection

2.1 Display installation

Installation instructions

- This machine should be installed adjacent to an easily pluggable AC power socket.
- For the sake of safety, we suggest that suitable wall-mounted bracket or base be used.
- In order to prevent injury, this machine shall be placed on a stable and level surface or fixed on a firm wall.
- For wall-mounting, please ask a professional to do so. Improper installation may cause instability of this machine.
- DO NOT place this machine in places with mechanical vibration.
- DO NOT place this machine in places where insects are accessible.
- DO NOT install this machine directly opposite to air-conditioner, otherwise its inner panel may be dewed and cause failure.
- DO NOT place this machine in places with strong electromagnetic field, otherwise it may be interfered by the electromagnetic wave and get damaged.

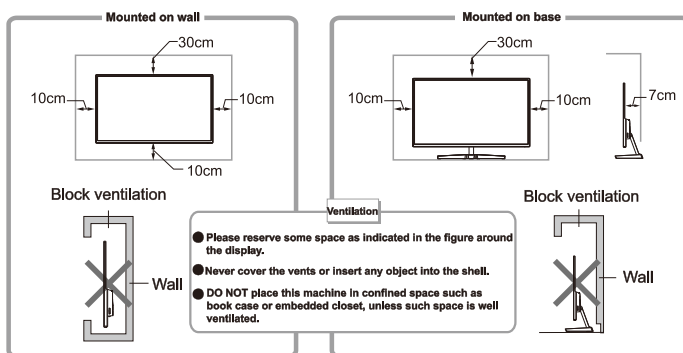

2.2 Signal line connection

Connect the signal line to output interfaces signal of VGA/HDMI/DVI signals of PC, and then connect the other end of the signal line to the corresponding signal input port of the display.

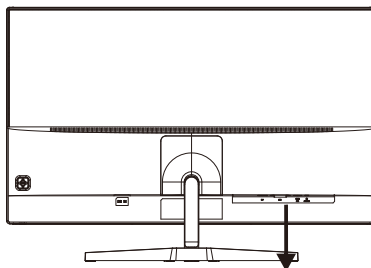

2.3 Earphone connection

This machine supports earphone audio output and external speaker.



3. Operation of Display

The OSD control buttons are shown as the figure. Models of the same product series are only different in button position and panel pattern, please refer to the practical model.

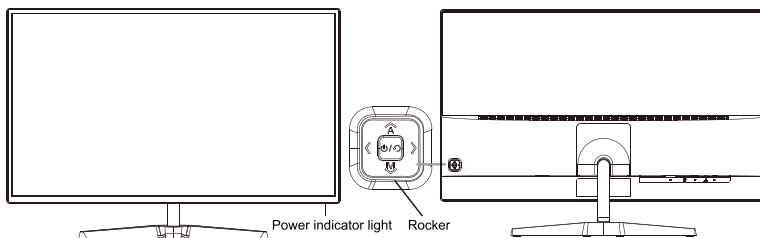

3.1 Power indicator light

When the display is working normally, the indicator light is off; when it is in the energy saving state, the indicator light blinks; when the signals are sent again in the energy saving state, the machine will return to normal work; when the machine is in the standby state, the indicator light is on. As the display is still powered in the standby state, for the sake of safety, the power cord should be unplugged when the display is not used.

3.2 Rocker function introduction

Rocker:

1. During standby, press the rocker to start monitor.
2. under normal working, long pressing the rocker to shut down the monitor.
3. When there is OSD menu displaying, press rocker to return to the previous menu, other function of rocker refers to OSD menu operation instruction.
4. When there is no OSD menu displaying, up pressing rocker to finish auto adjusting function ,adjust machine geometric status to the best state(only effective under VGA mode), down pressing rocker to adjust OSD menu, left/ right pressing rocker to adjust sound volume(only effective when this machine has speaker).

OSD menu operation description

1. Move rocker down to show the main menu on the screen.
2. Move rocker up/down to select the adjustment sort menu: Luminance, Image Setup, Color Temp., OSD Setup, Reset.
3. Move rocker right to enter the adjustment sort menu.
4. Move rocker up/down to select an item in the sort menu.
5. Move rocker right to enter the item.
6. Move rocker left/right to adjust the value or setting.
7. Press rocker to return to previous menu.
8. During menu operation, the icons of invalid options will change into grey.

3.3 Safety protection

When the video signals of PC exceeds the frequency range of the display, the horizontal and field synchronizing signals will be shut down to protect the display. Then, you have to set the PC output frequency to an acceptable range so as to make the display work normally.

4. Basic Troubleshooting

Phenomenon	Troubleshooting
1. Light out/power indicator light is off	Check whether the display and the socket are well connected to power, and whether the display is in the shutdown mode.
2. Image blurring, over-large, over-small, etc.	Enter the menu "Image Setting" and select "Auto Image Adjust" to automatically adjust the display.
3. Image over dark	Enter the menu "Brightness and Contrast" to adjust the brightness and contrast of the display.
4. Display over heat	Leave at least 5cm of distance for ventilation around the display and do not place articles on the display.
5. Dark/ light spots when powering on	This is a normal phenomenon. It is due to the backlight illuminates unevenly at the initial phase of powering on caused by temperature difference. The backlight can illuminate normally after 20 minutes, and then the dark/light spots will be corrected.
6. Image distortion, blinking, shaking	Check computer setting, select the correct resolution and re-adjust the refresh frequency.
7. Power off noise	It is a normal phenomenon caused by display discharging in the process of powering off.

5. Technical Specifications of Product

Panel size	31.5"
Optimal working resolution	1920×1080@60Hz
Power input	100-240VAC 60/50Hz
Product has been filed on China energy label website	Yes
Blue-light filtering	Support
Flicker-free	Support
Requirements for working environment	
Barometric pressure	86kpa~104kpa
Working temperature and humidity	0°C~40°C 20%~85%
Warehousing temperature and humidity	-10°C~60°C 10%~90%
Packing size (W * H * T) and weight	
Unpacked size (W * H * T) (with base)	724×503×183(mm ³)
Packing size (W * H * T)	880×510×120(mm ³)
Net weight	5.5kg
Gross weight	7.3kg

Power supply management system

Mode	Power consumption
Normal working	≤45W
Standby	≤0.5W

Remarks: All technical specifications in this manual and external packages are subject to change without further notice. In case that there is subtle difference between this manual and practical operation, please follow practical operation.

6. Instruction of Base Installation

1. Hold and press the hat and then lift it up from the back cover (Pic-1)
 2. Install the metal support to the back screw holes as in Pic-2, use 4 PCS machine screws to lock the support and back.
 3. Cover the small hat cross the support as in Pic-3
 4. Install the base to the screw hole below the support as the arrow direction, and lock 1 PCS machine screw as in Pic-4
- Note: disassemble the base according to the opposite order above.

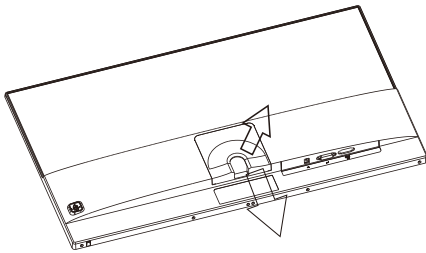

Pic-1

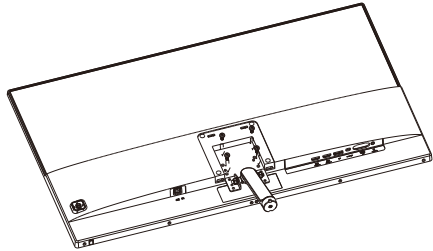

Pic-2

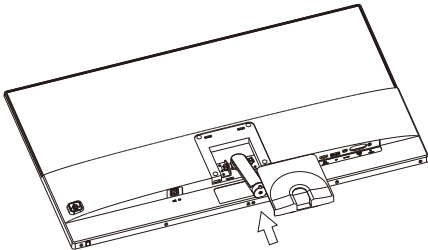

Pic-3

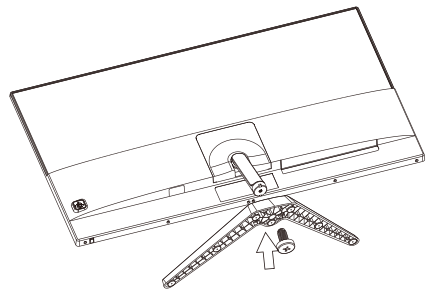

Pic-4

 **NOTE**

Remark: In case that there is subtle difference between this manual and the monitor, please follow the practical goods.



See Far, Go Further